



## Ditchling Road

£230,000

Looking out over the green of The Level and perfectly positioned to reach the North Laine, Brighton Station, and Brighton Beach on foot; this stylish one-bedroom property will appeal to many.

With a bright living/dining room and modern kitchen, as well as a spacious double bedroom, this property would make an excellent first home or investment purchase.



1



1



1



E

Ditchling Road, BN1

£230,000

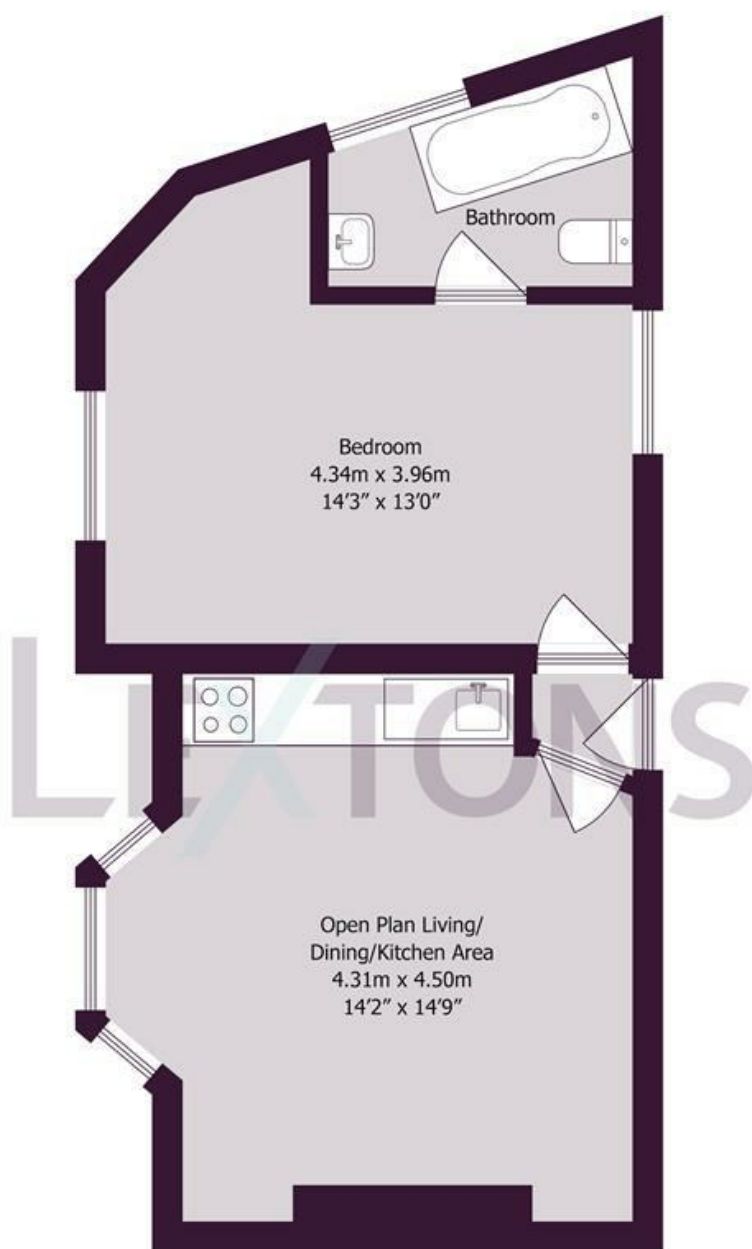

Approximate gross internal floor area 37 sq m/ 398 sq ft

Whilst every care has been taken to ensure accuracy, dimensions are approximate and for illustrative purposes only.

Created by Property Photography UK for Lextons. All rights reserved.

Meet us here...

35 South Road  
Brighton  
BN1 6SB

We aim to make our particulars both accurate and reliable. However they are not guaranteed; nor do they form part of an offer or contract. If you require clarification on any points then please contact us, especially if you're traveling some distance to view. Please note that appliances and heating systems have not been tested and therefore no warranties can be given as to their good working order.